



Rocket Door Frames

POCKET DOOR JAMBS

FITTING INSTRUCTIONS

HERE IS A QUICK AND EASY WAY TO FIT YOUR JAMBS FOR BOTH 35 AND 44 MM THICK DOORS

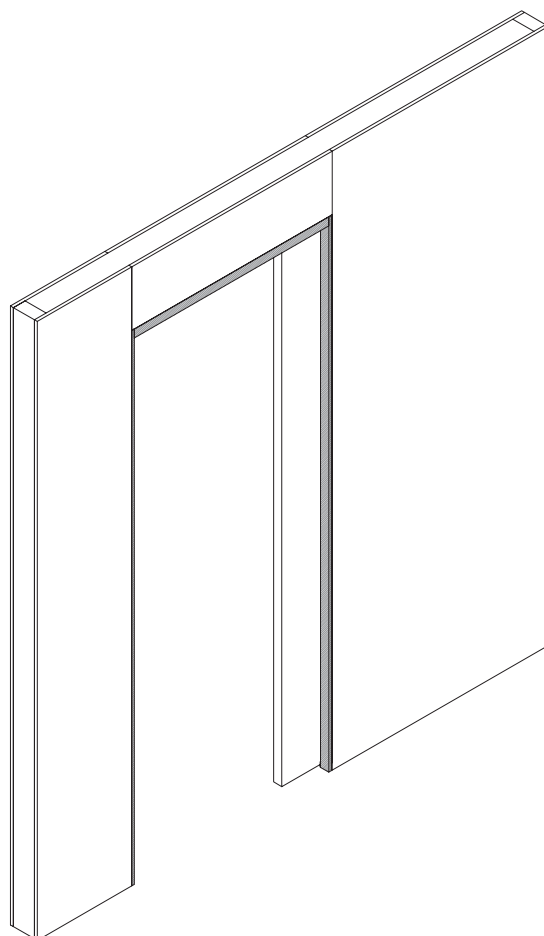

EACH KIT CONTAINS:



A)
Verticals with routing
for pocket entrance
2x



B)
Verticals without routing
for door post
2x

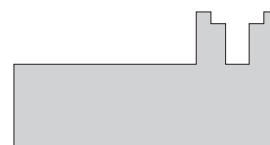

C)
Horizontal header with routing
1x



D)
4 mm brushes
Use with 35 mm door only
3x



E)
Plastic strip replacing brushes
in header for 44 mm door
3x

NEED HELP? GIVE US A CALL 03309980617

FITTING THE VERTICAL SECTIONS (A & B)

**WE RECOMMEND YOU PAINT THE JAMBS BEFORE INSTALLATION
TO AVOID GETTING PAINT ON BRUSHES AND PLASTIC STRIP.**

If the framework is installed at finished floor level

- for A 2040 mm door there is no need to cut A or B
- for A 2032 mm door cut A and B to 2027 mm
- for A 1981 mm door cut A and B to 1976 mm

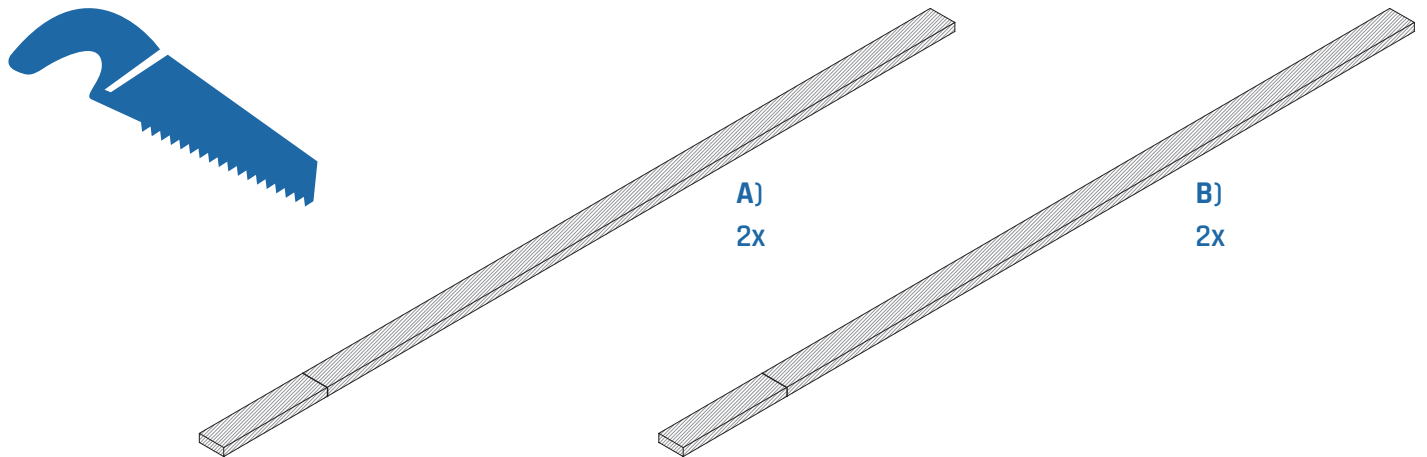

If the framework is not installed at finished floor level then cut A and B as shown below

X = 41 mm.

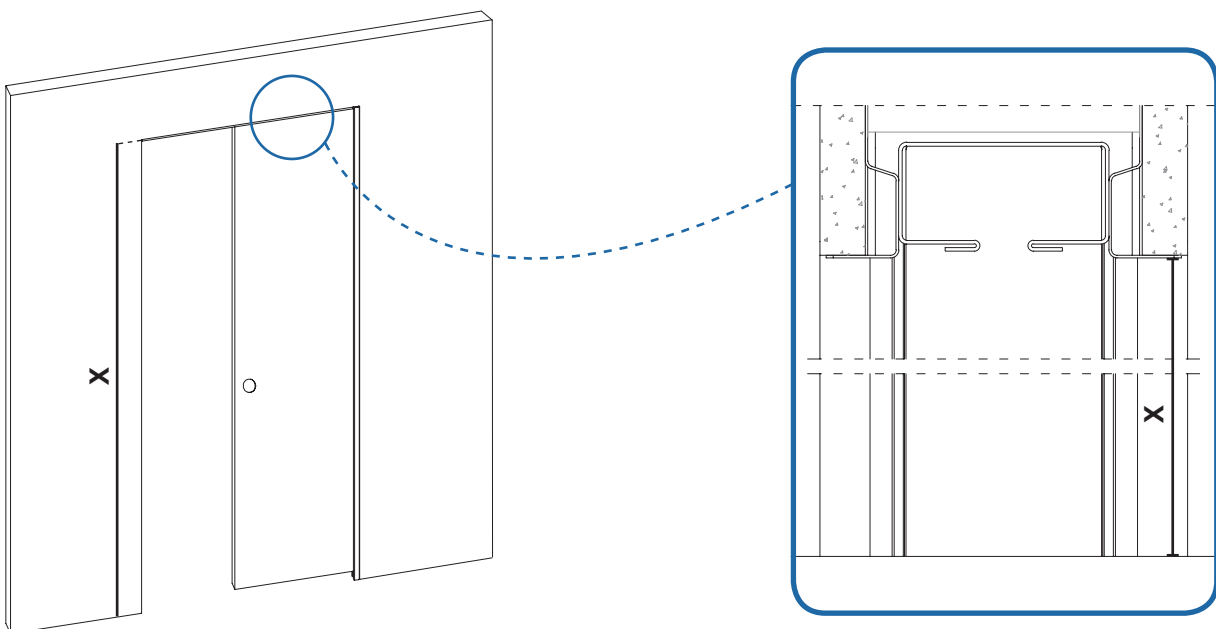

FITTING THE VERTICAL SECTIONS (A & B)

The brushes are designed for use with 35 mm doors only.

Do not fit to 44 mm doors

For 35mm doors cut brushes (D) to the lengths of A & B and fit to the jamb pocket entrance verticals (A)

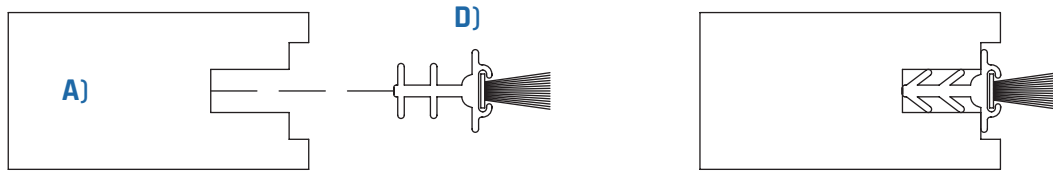

ATTACHING THE VERTICALS TO THE STEEL FRAME

Use 4x 100 mm lines of silicon equally spaced along each vertical and attach to the frame.

IMPORTANT - The verticals with the brushes are for the pocket entrance only

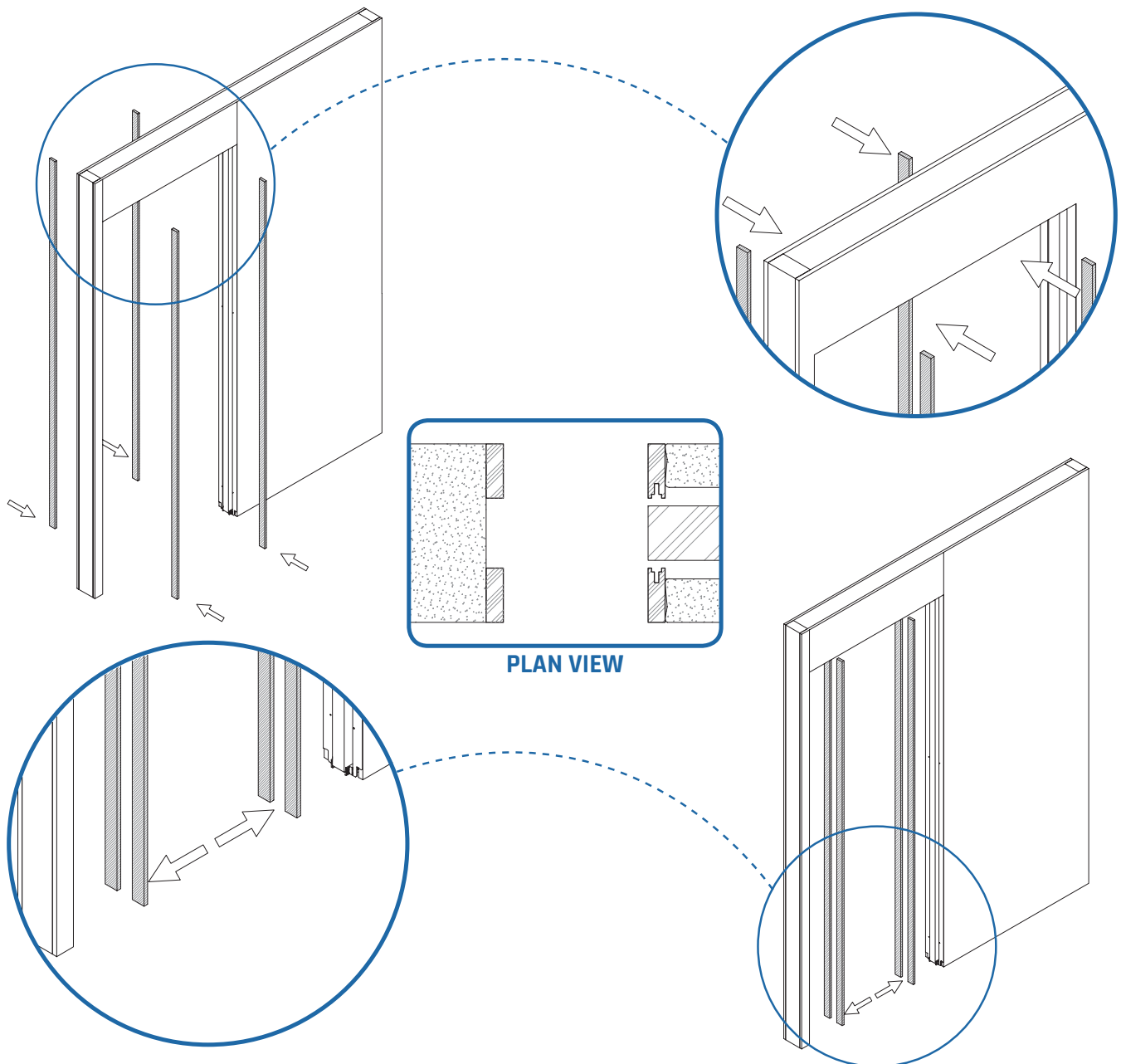

NEED HELP? GIVE US A CALL 03309980617

FITTING THE HEADER (C)

Measure the distance y and cut the header (C) accordingly

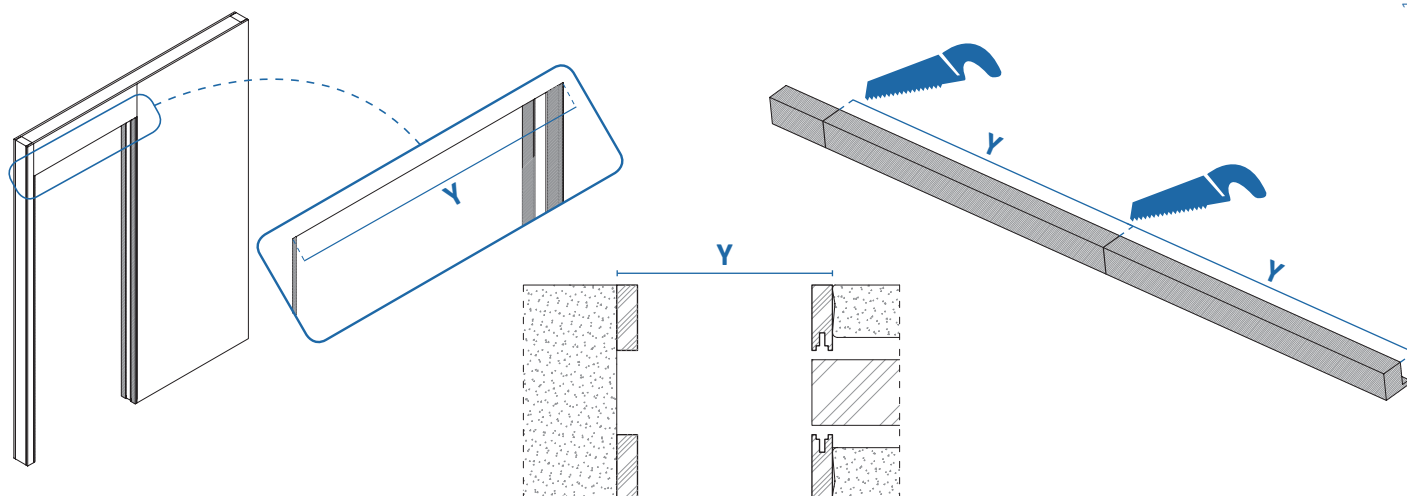

For 35 mm Doors - Cut brushes (D) to dimension Y and insert into both headers (C)

For 44 mm Doors - Cut plastic strip (E) to dimension Y and insert into both headers (C)

Brushes for 35 mm
doors only

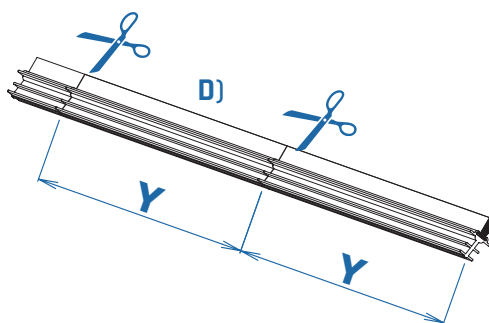

Apply silicon to the top of the verticals A and B and to the bottom of the plasterboard brackets and fix header into place.

